

Parts List

ITEM	QTY	PART #	DESCRIPTION
1	1	A02411	BEARING
2	1	A02702B	BASE PLATE
3	1	A02704	BRACKET
4	1	A02705	VALVEBODY
5	1	A03701	CAP
6	1	A03705	COVER
7	1	A05401	ECCENTRIC
8	4	A06401A	FOOT
9	1	A08701	HOUSING
10	1	A08703	HEAD
11	1	A13433	MOTOR
12	1	A14401	COUNTERWEIGHT
13	1	A16701	PLATE
14	1	A18402	TOLERANCE RING
15	1	A18701	CONROD
16	1	A19013	SCREW
17	2	A19418	SCREW
18	4	A19419	HOUSING SCREW
19	4	A19613	HEAD BOLT
20	1	A19707	PLATE SCREW
21	8	A19718	SCREW
22	4	A23402	LOCK WASHER
23	1	*A04709	DIAPHRAGM
24	1	*A07701	GASKET
25	1	*A23461	SMALL WASHER
26	1	*A23701	LARGE WASHER

\*RECOMMENDED SPARE PARTS KIT

DIAPHRAGM KIT	
11706	TEFLON/VITON
11711	2-PLY TEFLON

INCLUDES ITEMS 23-26

ALTERNATE PLATE SCREWS	
A19707	PLATE SCREW - 316ss
A19711	PLATE SCREW - 316ss TEF CO

ALTERNATE AND OPTIONAL PARTS	
A02705	VALVEBODY - 316ss
A02706	VALVEBODY - ALUM
A02709	VALVEBODY - 316ss TEF CO
A02710	VALVEBODY - ALUM TEF CO
A02795	VALVEBODY - SILCONERT
A04709	DIAPHRAGM - TEFLON/VITON
A04711	DIAPHRAGM - 2-PLY TEFLON
A08703	HEAD - 316ss
A08704	HEAD - ALUM
A08707	HEAD - 316ss TEF CO
A08708	HEAD - ALUM TEF CO
A08793	HEAD - SILCONERT
A16701	PLATE - 316ss
A16705	PLATE - 316ss TEF CO
A16791	PLATE - SILCONERT
A07701	GASKET - TEFLON
A07705	GASKET - VITON

ADS-125 08/05/14

ALTERNATE MOTORS

A13433 12 volt  
A13438 24 volt

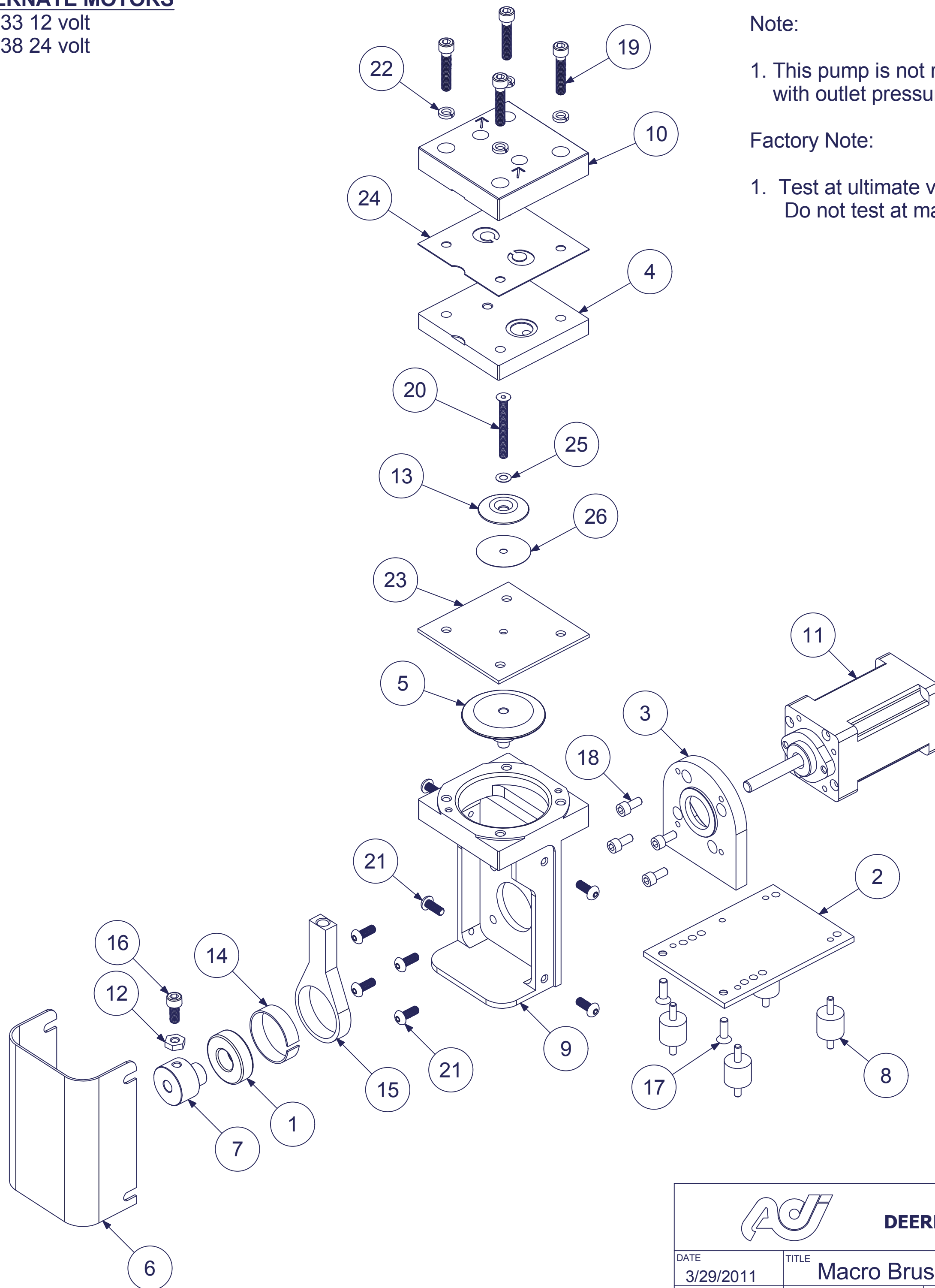

Note:

1. This pump is not recommended for use with outlet pressures above atmospheric.

Factory Note:

1. Test at ultimate vacuum and open flow only. Do not test at max pressure.

03/12 (1503) FM309

		<b>AIR DIMENSIONS INC.</b> DEERFIELD BEACH, FL. USA 33442 WWW.AIRDIMENSIONS.COM	
DATE	3/29/2011	TITLE	Macro Brushless DC Pump
APPROVED BY	FDM	DWG NO	Jxx1-xx-Kx0
		MODEL #	Jxx1-xx-Kx0
			SHEET 2 OF 3